

# ACES LIBRARY

Information & Alumni Center

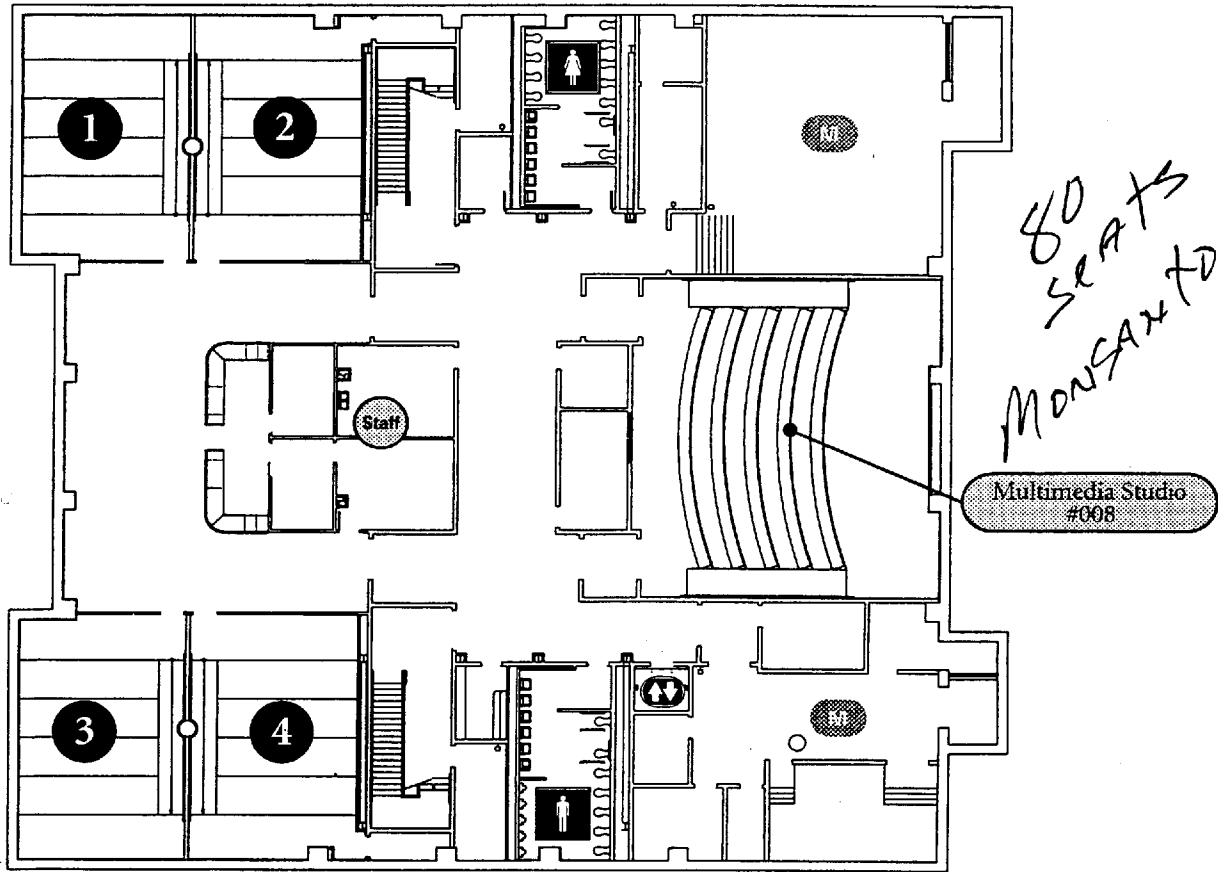

## Russell T. and Florence O. Odell Information Center

### Lower Level

1/ Estate of Irwin R. Tucker  
*Instruction Lab #029*

2/ Estate of Martha L. Dunlap  
*Instruction Lab #030*

3/ Estate of Laura M. Weber  
*Instruction Lab #023*

4/ Martha Gassmann Kraeger and John F. Kraeger  
*Instruction Lab #022*



# ACES LIBRARY

Information & Alumni Center

24 people

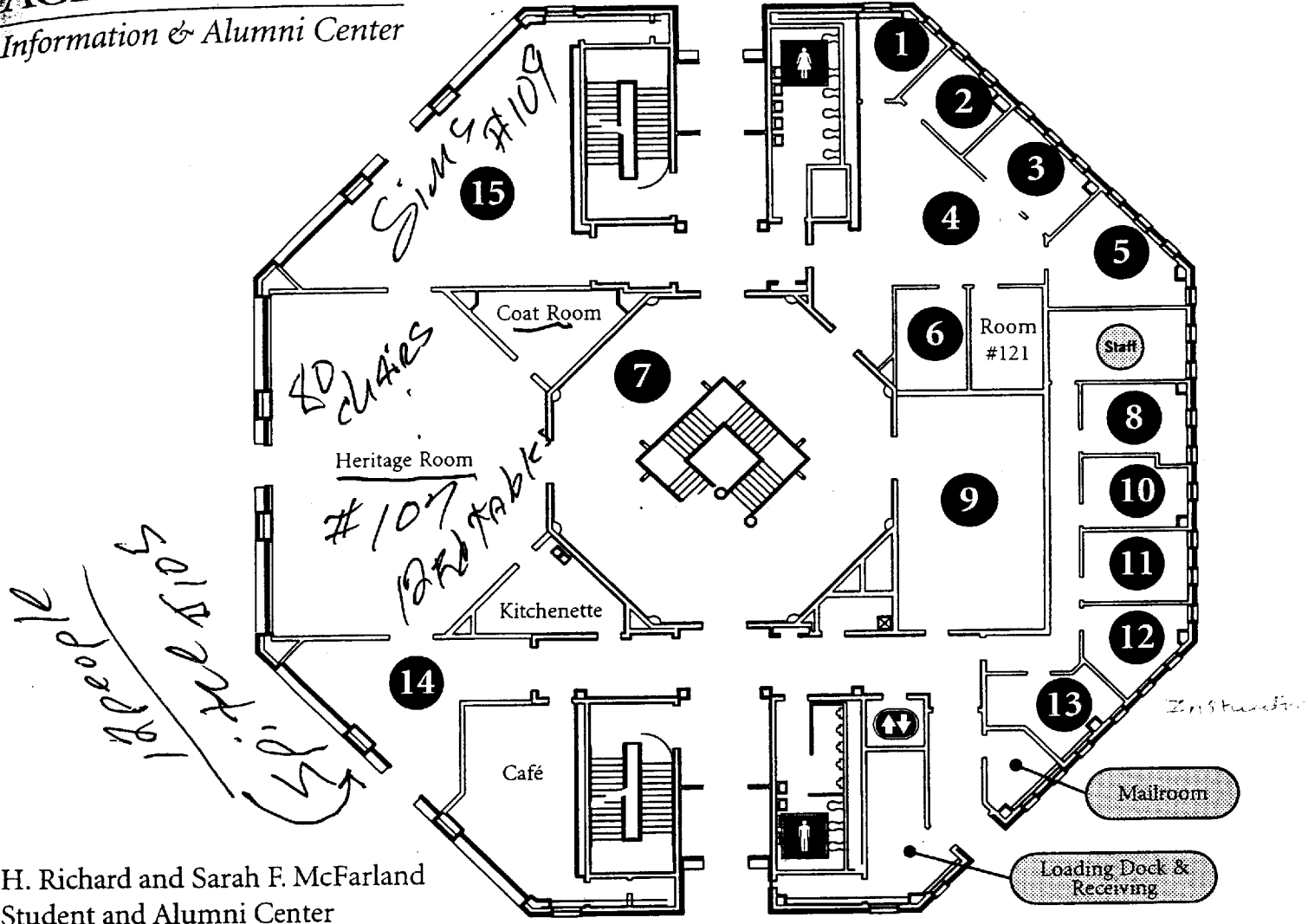

H. Richard and Sarah F. McFarland  
Student and Alumni Center

## Ground Level



	ELEVATOR
	MECHANICAL
	MEN'S RESTROOM
	STAFF OFFICES
	WOMEN'S RESTROOM

1/ R. Rex and Dorothy Giese Emory  
Interview Room, #117

2/ John F. Rundquist and Anita Turner Rundquist, Alumni Office, #118

3/ John R. and Eunice J. Campbell, Career Services Office, #119

4/ Barbara A. Kochanowski and Kenneth A. Poirier  
Career Center and Resource Area, #115

5/ Frederic B. and Ruth H. Hoppin, Academic Programs Office, #120

6/ William L. and Marilyn George  
Academy of Teaching Excellence Conference Room, #122

7/ Larry G. and Ann Zumwalt Gerdes and Steven H. Gerdes  
Building Commons, ground floor lobby

8/ John and Marion Kruesi, Computing Office, #125

9/ Lee L. and Mary Morgan/Caterpillar Foundation, Conference Center, #130

10/ Marion K. Piper  
Computing Office, #126

11/ Barbara Forgy Schock, Computing Office, #127

12/ Ollie B. and Dorothy D. Myers, Computing Office, #128

13/ Van E. and Joanne D. Trimble  
Computing Office, #129

14/ Robert G. F. Spitze and Hazel Taylor Spitze  
Conference Room, #105

15/ Fay M. Sims  
Executive Center, #109

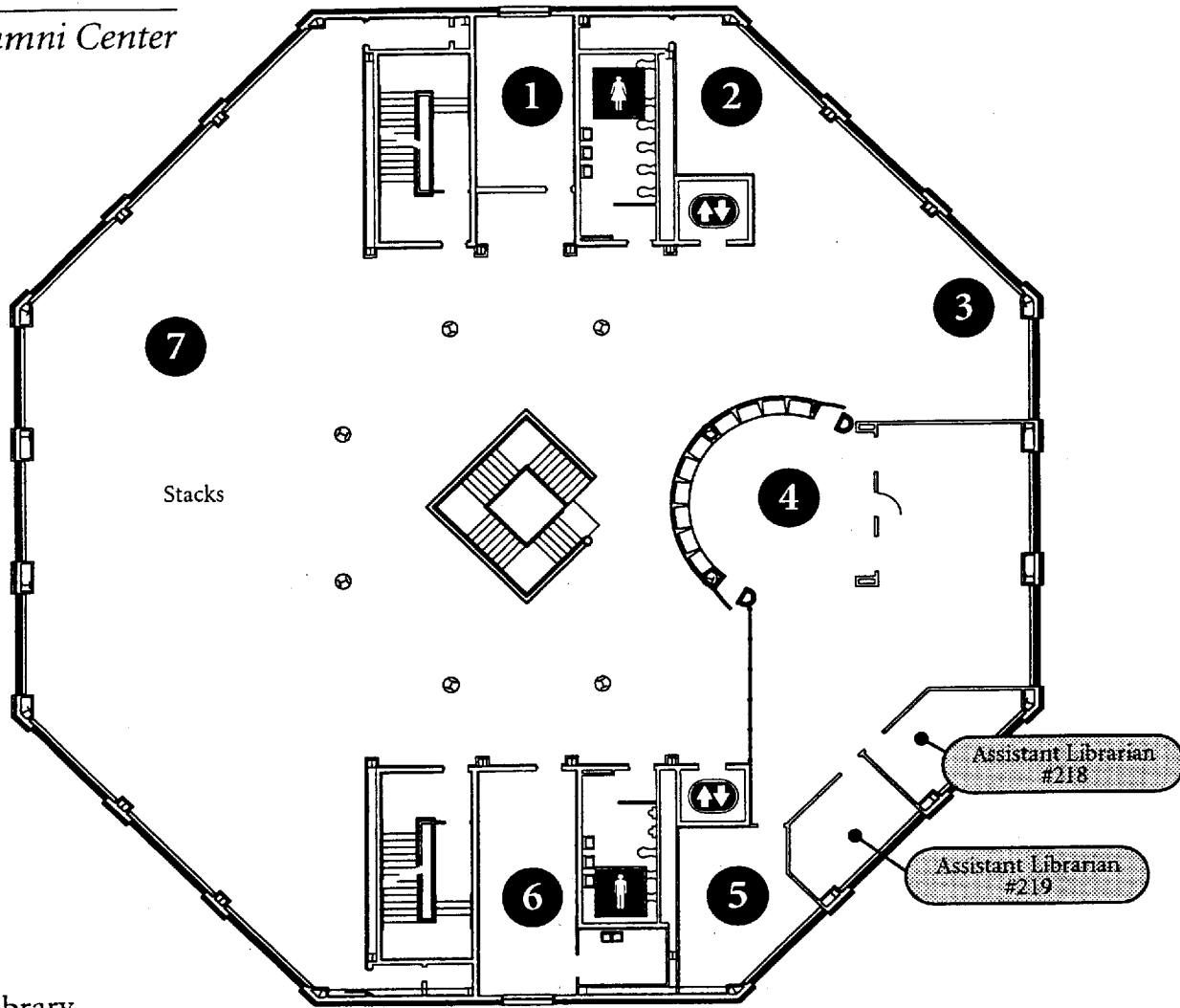

Isaac Funk Family Library

**Second Level**

**1/** Orville O. and Lorraine Mowery  
*Conference Room, #206*

**2/** William J. Condon  
*Reference Area*

**3/** Ted H. Funk  
*Ag Statistics Alcove*

**4/** Arleigh K. and Mabel E. Hohenboken  
*Circulation Desk*

**6/** Lawrence F. and Jean L. Kahl, *The Kahl-Funkhouser Faculty Lounge, #201*

**7/** Ruth Margaret Burwash, *New Journals*

**5/** Sue Wright Freytag and James E. Freytag and Harold W. and Ruth Beale Wright, *Head Librarian Office, #220*



	ELEVATOR
	MECHANICAL
	MEN'S RESTROOM
	STAFF OFFICES
	WOMEN'S RESTROOM

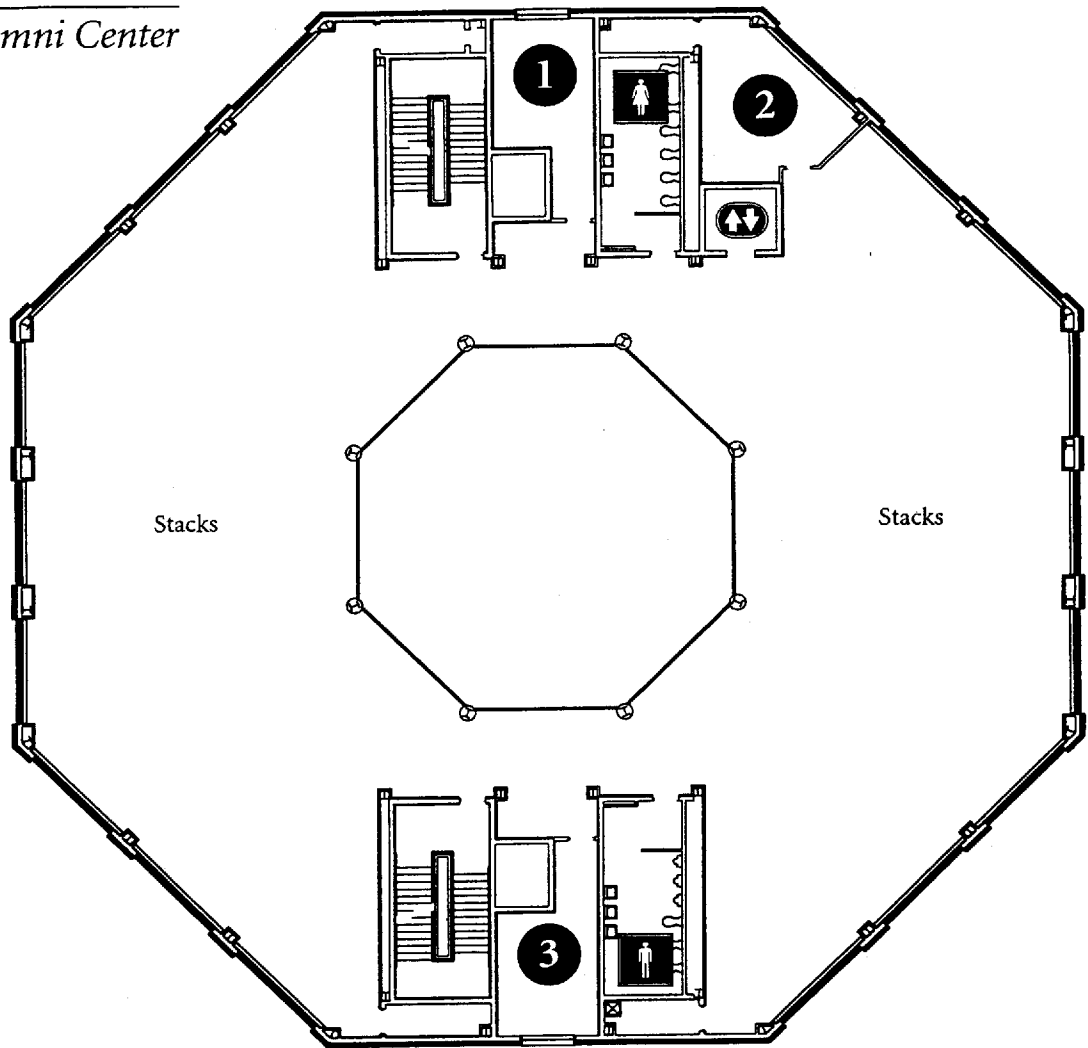



**Third Level**

**1/** Champaign County  
 Seed Company, *Group  
 Study Room, #305*

**2/** James R. and Helen  
 Elliott Davies, *Group  
 Study Room, #309*

**3/** Orville G. and Nolie  
 Bentley, *Group Study  
 Room, #301*



-  ELEVATOR
-  MECHANICAL
-  MEN'S RESTROOM
-  STAFF OFFICES
-  WOMEN'S RESTROOM

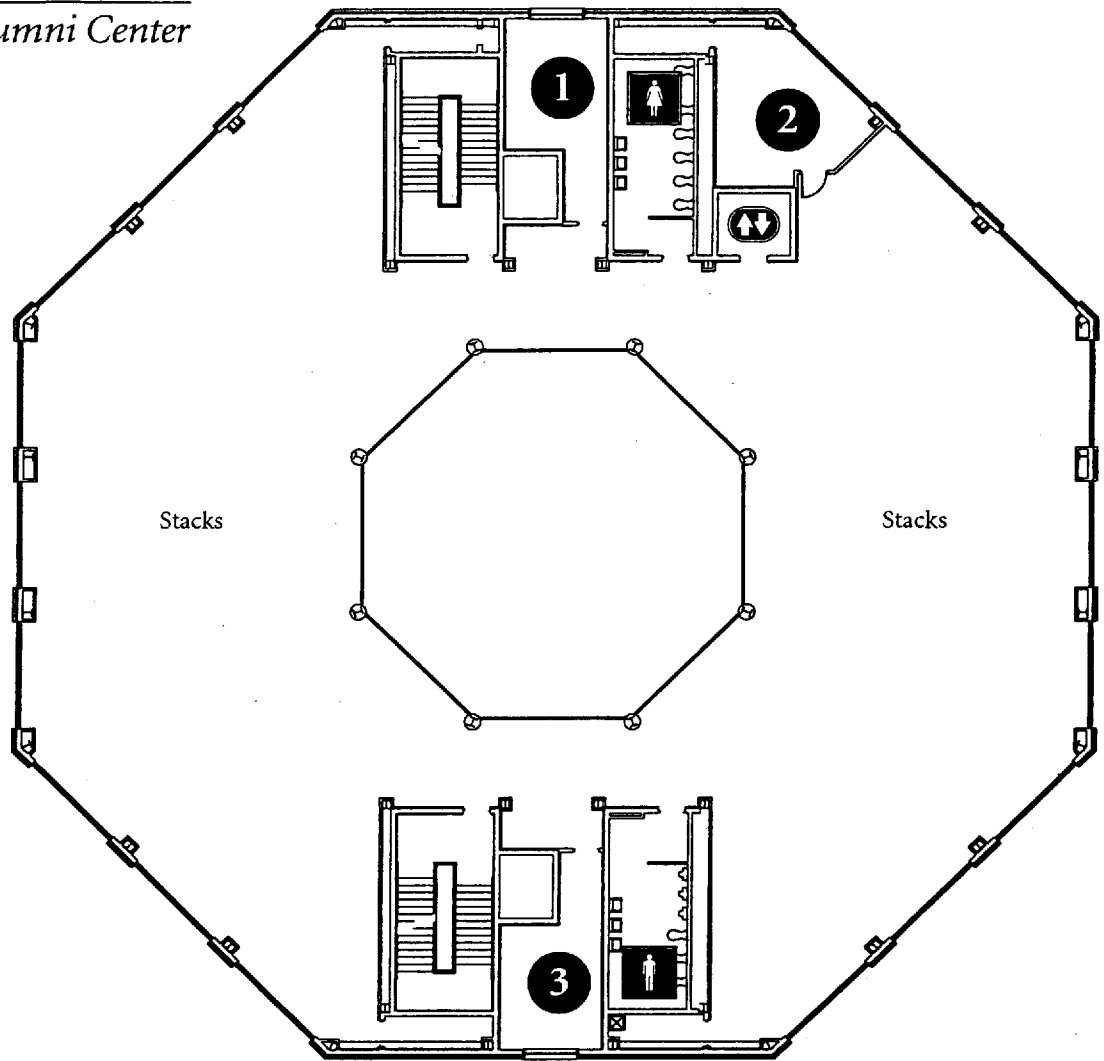





**Fourth Level**

1/ The College of Agriculture Class of 1941, *Group Study Room, #405*

2/ Maydee Lehman *Group Study Room, #409*

3/ Ralph Allen Family *Group Study Room, #401*



-  ELEVATOR
-  MECHANICAL
-  MEN'S RESTROOM
-  STAFF OFFICES
-  WOMEN'S RESTROOM

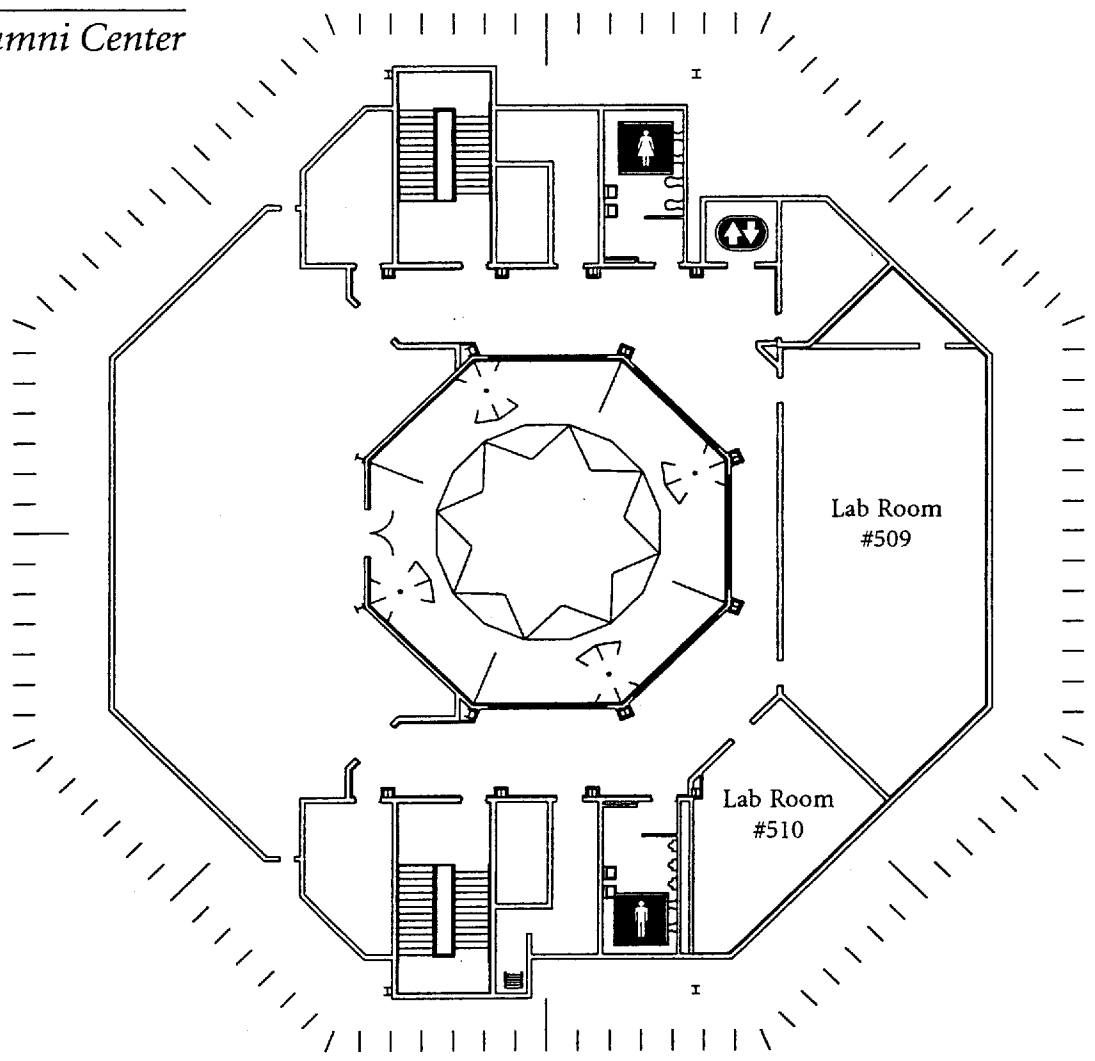

**Fifth Level**



-  ELEVATOR
-  MECHANICAL
-  MEN'S RESTROOM
-  STAFF OFFICES
-  WOMEN'S RESTROOM